

## SUBMITTAL DATA

JOB/CUSTOMER:	SUBMITTED BY:
ENGINEER:	APPROVED BY:
CONTRACTOR:	ORDER NO:
SPECIFICATION REFERENCE:	



## DESCRIPTION

The DCKB-SS3 D'MAND CIRC® System (110V) is recommended for use with hot water lines sized ½" to 2" in OD diameter. This 110V 5A controller with 33GPM Pump is used in light commercial applications and multifamily buildings.

This System will come pre-set for the most efficient settings and can easily be field adjusted to customize it to the specific application.

INDOOR USE ONLY.

## INCLUDES

*The Original D'MAND CIRC® System* Standard package comes with:

- |   |                |                  |
|---|----------------|------------------|
| (1) SS3-200 Pump                          | (1) Thermistor | (1) Anchor Pack  |
| (1) DCKB Control Box with Power Cord      |                | (1) Sensor Clamp |
| (1) D'MAND CIRC® Commercial Circuit Board |                |                  |

## TECHNICAL DATA

### Control Box

- Power Supply 110V/115V
- Three (3) prong adapter
- 10k thermistor with 6' lead
- Adaptable circuit board controller with integrated 5 amp fuse

### Pump

- |                                |                               |
|--------------------------------|-------------------------------|
| Flow Range: 0-33 gpm           | RPM/HP : 262 hp               |
| Max. Working Pressure: 145 psi | Min. Fluid temperature: 36°F  |
| Head Range: 0-29 ft.           | Max. Fluid temperature: 230°F |
| Connectors: Gf 15/26 flange    | Voltage (max. spd.):          |
| (with ¾" stainless steel)      | 115V/197watts/1.80Amps        |
| MIP not shown in picture)      | Approx Ship Weight: 15 lbs    |
| Motors: 2 pole single phase    |                               |

## APPLICATIONS

These are for INDOOR USE ONLY and cannot be used in areas that may have direct exposure to water or extreme heat.

The D'MAND CIRC® Kontrols™ Box (110V) is recommended for use with hot water lines sized from ½" to 2" in OD diameter. This 110V 5A controller with 10K thermistor is used in light commercial applications and multi-family buildings.

## DIMENSIONS

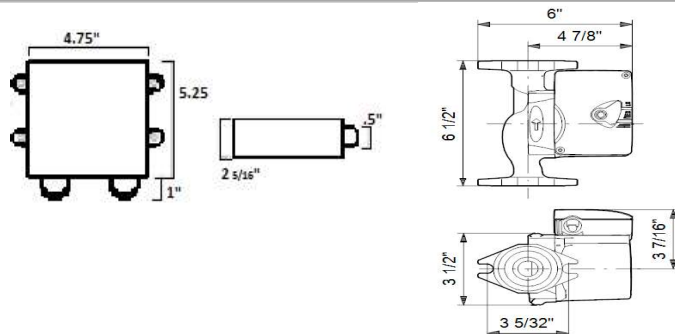

## WARRANTY

ACT, Inc. will replace without charge (at the Company's option) any D'MAND Kontrols® pump, valve, or component part which is proven defective under normal use. Warranty – (Five Years from date of purchase) Accessories: Hard-Wired Buttons, Wireless Transmitters and Receivers, all Hard-Wired or Wireless Motion Sensors and Receivers; Parts; Flex Lines and Tee's; Warranty – (One Year from date of purchase.) Labor is not included with Limited Warranty.

In order to obtain services under this warranty, it is the responsibility of the purchaser to promptly notify the Company in writing and promptly deliver the item in question, delivery prepaid to the factory. The address for notification and delivery is ACT, Inc. D'MAND Kontrols® Systems, 3176 Pullman Street, Suite 119, Costa Mesa CA 92626. If the product or part in question contains no defects as covered in the warranty, the purchaser will be notified and billed for parts and labor charges in effect at the time of factory examination and repair.